



INSTRUCTION BULLETIN

No. 340446
Machine: ATLV 4300
Published: 9-00/00
System: OPTIONS

NOTE: DO NOT DISCARD the Parts List from the Instruction Bulletin. Place the Parts List in the appropriate place in your machine manual for future reference. Retaining the Parts List will make it easier to reorder individual parts and will save you the cost of ordering an entire kit.

NOTE: Numbers in parenthesis () are reference numbers for parts listed in Bill of Materials.

Installation instructions for kit number 368528

SYNOPSIS / PROBLEM:

This kit contains the parts needed to install a turf skirt on the model ATLV 4300 Litter Vac. Please follow step-by-step instructions.

SPECIAL TOOLS / CONSIDERATIONS: NONE

(Estimated time to complete: 1 hour)

PREPARATION:

(Refer to FIG. 1)

1. Start the machine. Raise the front vacuum head (option) all the way up.
2. Turn off the machine.

FOR SAFETY: Before leaving or servicing machine, stop on level surface and set parking brake. Then turn off machine and remove key.

INSTALLATION:

(Refer to FIG. 1)

1. Loosen the front skirt securing hardware. (Refer to FIG. 1)
2. Remove and set aside the rear skirt retainers front mounting hardware. (Refer to FIG. 1)
3. Slide out and remove the existing front skirt. (Refer to FIG. 1)
4. Replace the old front skirt with both the longer and backup skirts. (Refer to FIG. 1)
5. Tighten the front skirt securing hardware. (Refer to FIG. 1)
6. Reassemble the rear skirt mounting hardware. (Refer to FIG. 1)
7. Torque all front and rear skirt mounting hardware to 16-21 ft lbs.
8. Start the machine, and check the turf skirt for proper operation.

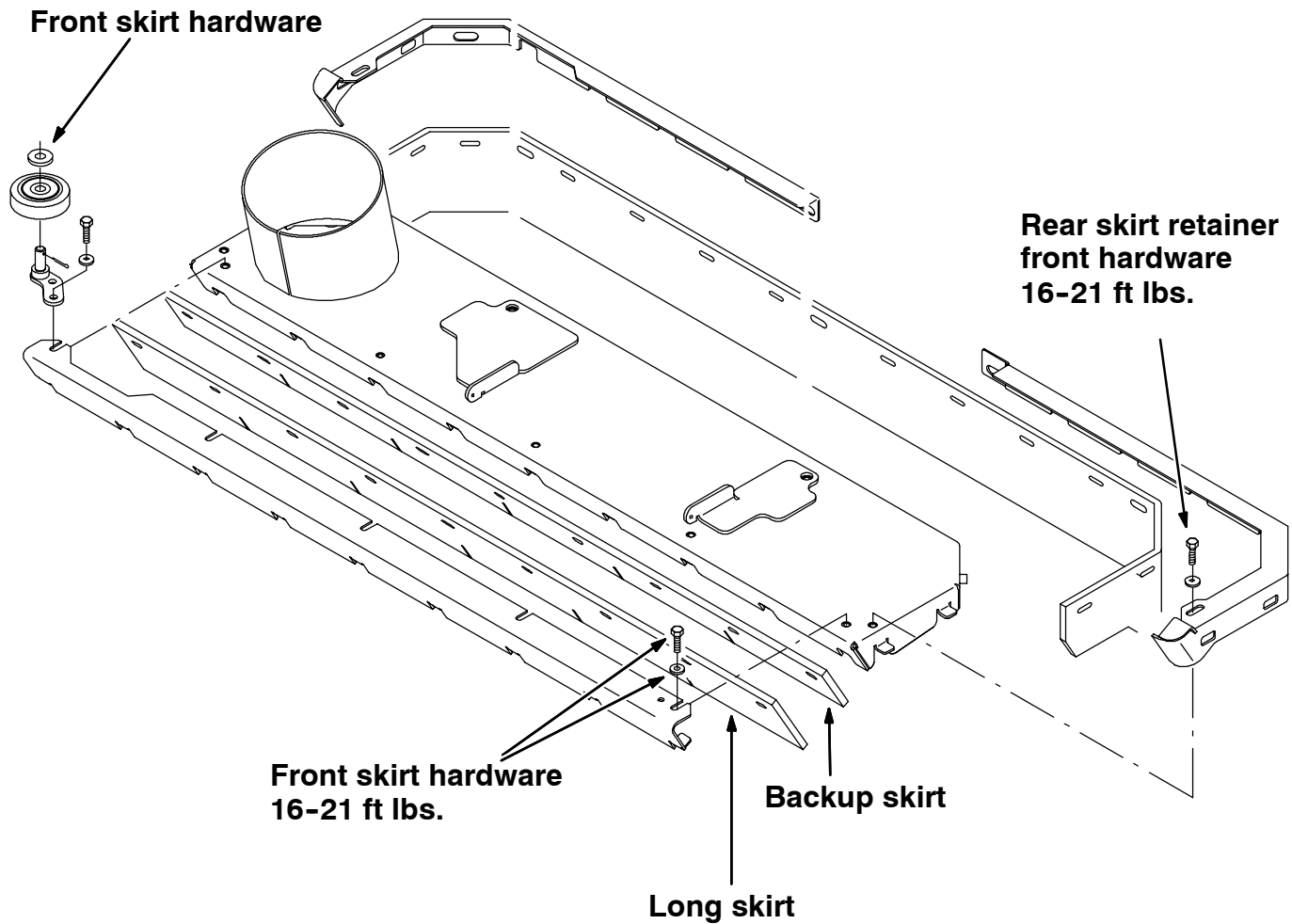

FIG. 1 - TURF SKIRT KIT INSTALLATION

BILL OF MATERIALS FOR ATLV 4300 TURF SKIRT KIT 368528

Ref.	TENNANT Part No.	Description	Qty.
1	368237	Blade, front	1
2	368238	Blade, backup	1

TENNANT COMPANY
P. O. Box 1452
Minneapolis, MN 55440-1452